

TMS SERIES FLOAT SWITCHES SIDE MOUNT LEVEL SWITCH

GENERAL FEATURES

With a robust mechanical hinged float, the TMS series are ideal for use in applications requiring reliable monitoring under strong flows. Available with two different mounting options. It is ideal for use in a range of applications and industries, such as the detection of liquid levels in water treatment vessels, mechanical engineering and plant construction. The switching function can be reversed by rotating the float switch, making this a highly flexible and cost-effective solution. With its reed sensor-based level measurement and mechanical hinge, it provides durable use even in strong flows.

Technical Features

| | |
|--------------------------|--|
| Body material | : PP, PA12 or HDPE |
| Mounting | : 1/2" BSP or 1/2" NPT |
| Connection | : 3 m (As standard) PVC cable outlet |
| Contact form | : Normally open (N.O.) or normally closed (N.C.) |
| Temperature range | : -25 °C to + 105 °C |
| Switching voltage | : Max. 200 VDC/ 250 VAC |
| Switching type | : Form-A Reed Switch |
| Switching current | : 1.5 A |
| Carry current | : 2 A |
| Protection class | : IP68 |
| Usage Areas | : Water, non-aggressive liquids, certain acids and bases (PP body) Water, oil, and non-aggressive liquids (PA12 body) Water and aggressive liquids (acids and bases), alkalis (HDPE) |
| Contact | : If the floater is hanging down while connecting to the tank, N.O. position |

| | |
|----------------------|---|
| Product codes | : TMS1A0B3MB (PP body, BSP, 3m) TMS2A0B3MB (PA12 body, BSP, 3m) TMS1A0N3MB (PP body, NPT, 3m) TMS2A0N3MB (PA12 body, NPT, 3m) TMS5A0B3MB (HDPE body, BSP, 3m) |
|----------------------|---|

Dimensions:

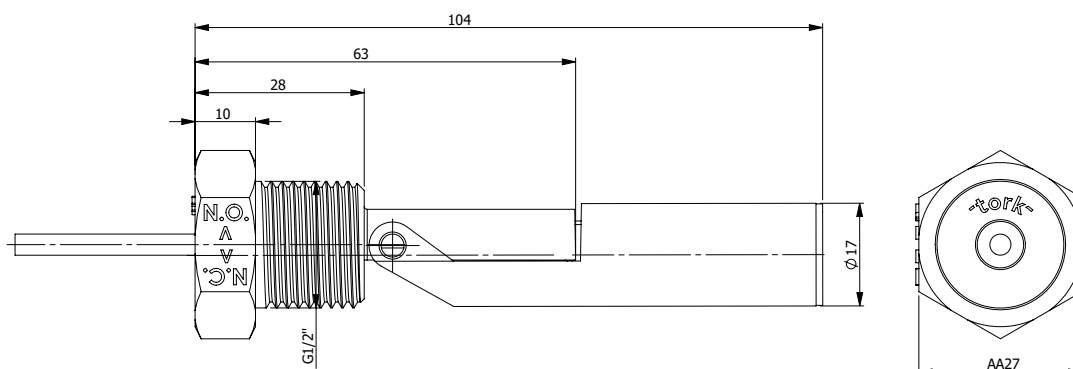

Connection Diagram:

