

# Compressor Solenoid Valves

## S5059 Series (G1/8")



- NORMALLY CLOSED • 3 WAY
- DIRECT ACTING

### General Features

- S5059 TORK series direct acting, high pressure valve, 3/2 way and normally closed
- Solenoid valves are used with filters
- Solenoid valve can be mounted in any position without affecting operation; vertical with coil upwards preferred.
- No pressure difference is required. Optionally, the solenoid valve can be mounted on the plate using four holes.

### Electrical Characteristic

Continuous Duty : ED %100  
 Coil Insulation Class : H (180°C)(IEC 85)  
 Coil Impregnation: : Güçlendirilmiş Fiber Glass  
 Ambient Temperature : -10° C...+60°C  
 Protection Degree : IP65 (ISO 60529) İstek Üzerine; IP68  
 Electric Plug Connection: DIN 46340 3 Kutuplu Soket (DIN436  
 Connector Specification : ISO 4400 / EN 175301-803 Form A,  
 Terminal (Kablo Ø6-8 mm)  
 Electrical Safety : IEC 335  
 Standard Voltages : AC 12V 15VA, 24V 15VA, 48V 15VA,  
 110V 15VA, 230V 15VA, 230V 24VA  
 DC 12V 18W, 24V 18W, 48V 18W, 110V 18W

On request other voltages  
 Voltages Tolerance : AC -15%, +10% DC -5%, +10%  
 Frequency : 50 Hz (60 Hz...)  
 On request; Connector with LED, PWM Socket  
 Siparişlerde bobin gerilimi veriniz. Detaylı bilgi için bobin bölümüne bakınız.

### Materials in Contact with Fluid

Body : Brass  
 Internal Parts : Stainless Steel  
 Sealing : VITON  
 Shading Ring : Copper (EN 12735-1)  
 Seats, Core Tube, Springs : Stainless Steel



#### DIRECT ACTING

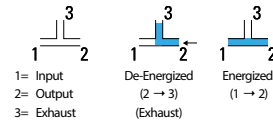

### Technical Features

Max. Viscosity : 5°E (-37cST or mm /s)  
 Response Time : Opening Time : 30 ms  
 Closing Time: 30 ms

### Option

Female connection : BSP, on request NPT  
 • On request manual control can be added.  
 • On request CR-Ni plated.  
 • On request PTFE coated.  
 • On request Atex (exproof) coil

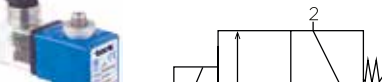
Solenoid Valve Symbol			Valve Type/ Order No	Con- nec- tion Size	Orifice Size	Max. Pressure (bar)		Kv	Sealing	Weight
DIRECT ACTING		S5059	G	mm	Bar	Bar	Lt/ min	VITON	kg	
		S505900010V	1/8"	1	0	16	0,5	✓	0,50	

# Compressor Solenoid Valves

## S5059 Series (G1/8")

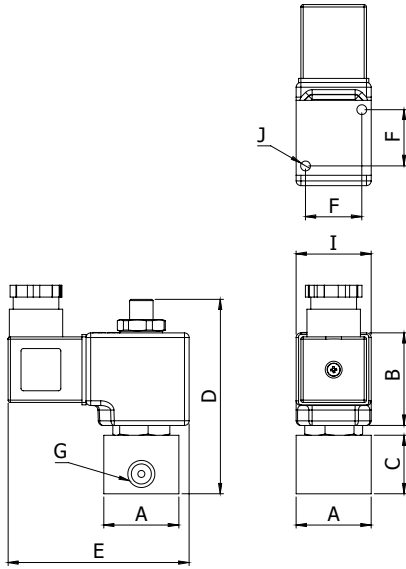

Direct Acting/ Dimensions (mm)								
G	A	B	C	D	E	F	I	J
1/8"	32	39,50	25	83	77	24	32	M5
1/4"	32	39,50	25	83	77	24	32	M5

### Coils & Sockets

- As standard use selected C40 series coil chosen for the appropriate voltage. Coil standard powers are 15VA or 18W. For other power values, please refer to the valve datasheet or contact the company.
- Sockets for C40 coils: C80 - standard socket, C81 - LED socket, C82 and C83- Power Save Socket PWM, C84 - AC to DC socket
- Complete factory assembled valves with coil and socket can be ordered, for that purpose after the valve body code specify the coil and socket.

For example; S1030.03.125.E-C40230VAC24VA-C80 is the S1030.03.125.E valve body with a C40 series coil 230V AC 24VA and C80 socket.

- For IP68 use a C42 series coil (C42 coils are with cable, no additional socket is necessary).
- For use in ATEX zones use a C41, C43, C46 or C47 series coil (All exproof coils are with cable, no additional socket is necessary).
- Detaylı bobin ve soket bilgileri için özel veri sayfalarına bakınız.

**C40:** Standard Coil

**C41 :** M Type Ex Proof Standard Coil

**C42 :** IP68 Coil

**C43 :** D Type Ex Proof Coil

**C46:** m Type Ex Proof Coil with Thermic Switch

**C47 :** m Type Ex Proof Coil with PWM Control

### Standards

•TORK solenoid valves 97/23/EC are available for pressure equipment directive (PED) and 2006/95/ECC low voltage directive (LVD).

Product specifications, design and availability are subject to change without notice. All rights reserved.